

"the original portable pool"
doughboy®

Wedgewood

Strap Oval Pool

Parts List

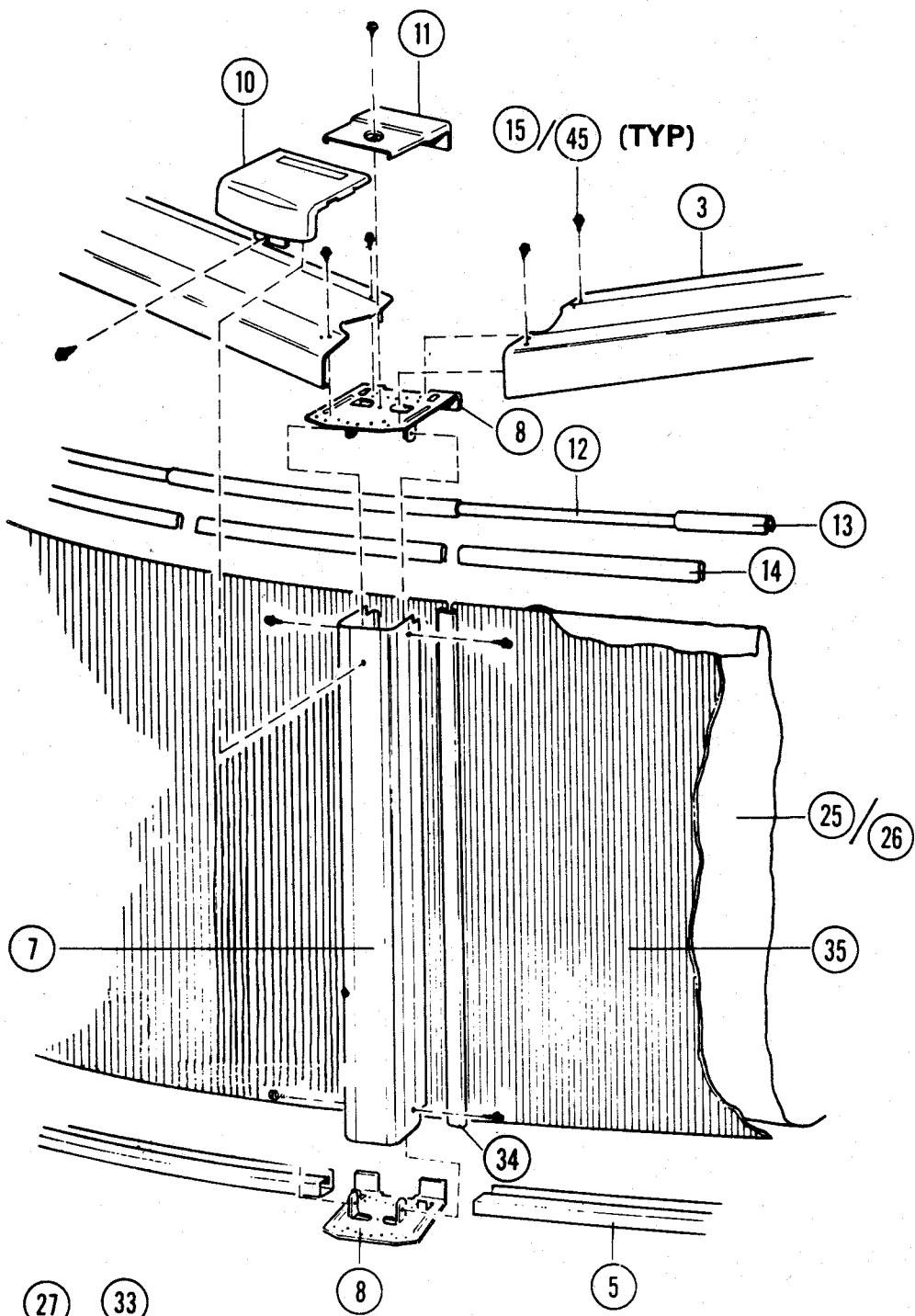

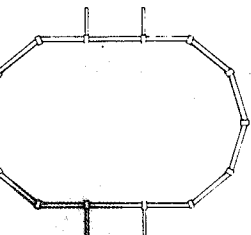
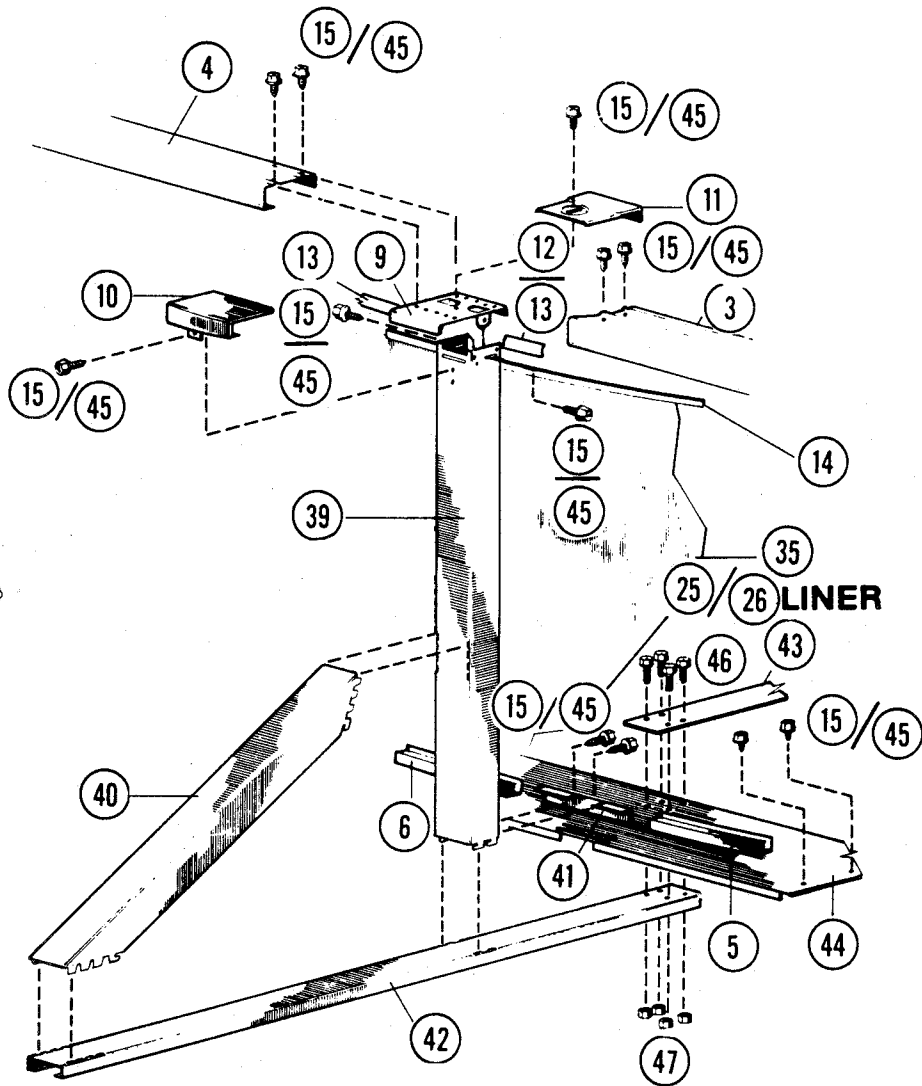

SIDE
VIEW

ITEM #	DESCRIPTION	20' x 12' x 48''		24' x 12' x 48''		28' x 12' x 48''		32' x 12' x 48''		40' x 12' x 48''		44' x 12' x 48''	
		PART #	QTY.	PART #	QTY.	PART #	QTY.	PART #	QTY.	PART #	QTY.	PART #	QTY.
	FRAME PACK "A" CARTON	0-9402-000	1	0-9442-000	1	0-9410-000	1	0-9422-000	1	0-9440-000	1	0-9444-000	1
1.	Parts List	573-2372	1	573-2372	1	573-2372	1	573-2372	1	573-2372	1	573-2372	1
2.	Pool Assy./Installation Instructions	573-2369	1	573-2369	1	573-2369	1	573-2369	1	573-2369	1	573-2369	1
3.	Top Rail	587-1159	12	587-1159	12	587-1159	12	587-1159	12	587-1159	12	587-1159	12
4.	Side Top Rail	587-1158	2	587-1158	4	587-1158	6	587-1158	8	587-1158	12	587-1158	14
5.	Bottom Rail (Stamped 12)	589-1046	12	589-1046	12	589-1046	12	589-1046	12	589-1046	12	589-1046	12
6.	Side Rail (Stamped S)	589-1052	2	589-1052	4	589-1052	6	589-1052	8	589-1052	12	589-1052	14
7.	Vertical	580-1516	10	580-1516	10	580-1516	10	580-1516	10	580-1516	10	580-1516	10
8.	Vertical End Cap	580-1146	20	580-1146	20	580-1146	20	580-1146	20	580-1146	20	580-1146	20
9.	Side Vertical Top Cap	580-1079	4	580-1079	6	580-1079	8	580-1079	10	580-1079	14	580-1079	16
10.	4" Outer Connector	580-1544	14	580-1544	16	580-1544	18	580-1544	20	580-1544	24	580-1544	26
11.	Inner Connector	5186-1154	14	5186-1154	16	5186-1154	18	5186-1154	20	5186-1154	24	5186-1154	26
12.	Stabilizer Rail, small dia.	583-1012	8	583-1012	8	583-1012	8	583-1012	8	583-1012	8	583-1012	8
13.	Stabilizer Rail, large dia.	583-1011	10	583-1011	12	583-1011	14	583-1011	16	583-1011	20	583-1011	22
14.	Plastic Coping, 24"	545-1001	28	545-1001	31	545-1001	35	545-1001	39	545-1001	47	545-1001	51
*15.	Sheet Metal Screw #10 x 3/8" Hexwasher Head, Type AB	510-1000	100	510-1000	100	510-1000	100	510-1000	100	510-1000	100	510-1000	100
16.	Safety First Handbook	573-2370	1	573-2370	1	573-2370	1	573-2370	1	573-2370	1	573-2370	1
17.	Brochure—Night Swimming & Lighting	573-2334	1	573-2334	1	573-2334	1	573-2334	1	573-2334	1	573-2334	1
18.	Brochure—Children Aren't	573-2338	1	573-2338	1	573-2338	1	573-2338	1	573-2338	1	573-2338	1
18A.	Brochure—Pool & Spa	573-2393	1	573-2393	1	573-2393	1	573-2393	1	573-2393	1	573-2393	1
19.	"Danger" Sign	560-1035	1	560-1035	1	560-1035	1	560-1035	1	560-1035	1	560-1035	1
20.	Adhesive Square	310-1034	4	310-1034	4	310-1034	4	310-1034	4	310-1034	4	310-1034	4
21.	Warranty Card	565-1070	1	565-1070	1	565-1070	1	565-1070	1	565-1070	1	565-1070	1
22.	Product Registration Card	565-1073	1	565-1073	1	565-1073	1	565-1073	1	565-1073	1	565-1073	1
23.	Booklet — Enjoy Your Pool	573-2124	1	573-2124	1	573-2124	1	573-2124	1	573-2124	1	573-2124	1
	POOL LINER CARTON												
24.	Chlorine/Winterizing Instructions	369-1134	1	369-1134	1	369-1134	1	369-1134	1	369-1134	1	369-1134	1
***25.	Pool Liner — 15 Mil (Standard)	0-2012-715	1	0-2412-715	1	0-2812-715	1	0-3212-715	1	---	---	---	---
***26.	Pool Liner — 20 Mil (Standard)	---	---	---	---	---	---	---	---	0-4012-720	1	0-4412-720	1
27.	"Danger" Decals	560-1036	2	560-1036	2	560-1036	2	560-1036	2	560-1036	2	560-1036	2
28.	Warranty Card — 15 Mil	565-1061	1	565-1061	1	565-1061	1	565-1061	1	---	---	---	---
29.	Warranty Card — 20 Mil	---	---	---	---	---	---	---	---	565-1062	1	565-1062	1
**30.	Repair Patch	564-1000	1	564-1000	1	564-1000	1	564-1000	1	564-1000	1	564-1000	1
31.	"Danger Shallow 3/2 Ft. Decal	560-1034	4	560-1034	4	560-1034	4	560-1034	4	560-1034	4	560-1034	4
32.	Danger Decal Installation Inst.	369-1133	1	369-1133	1	369-1133	1	369-1133	1	369-1133	1	369-1133	1
	SIDEWALL CARTON												
33.	Danger Decals	560-1036	2	560-1036	2	560-1036	2	560-1036	4	560-1036	4	560-1036	4
34.	Joint Piece	580-1002	1	580-1002	1	580-1002	1	580-1002	2	580-1002	2	580-1002	2
35.	Sidewall—Wedgewood	0-6108-002	1	0-6108-042	1	0-6108-010	1	0-6108-022	2	0-6108-040	2	0-6108-044	2
36.	Large Cover Plate—Wedgewood	580-1524	1	580-1524	1	580-1524	1	580-1524	2	580-1524	2	580-1524	2
37.	Small Cover Plate—Wedgewood	580-1518	1	580-1518	1	580-1518	1	580-1518	2	580-1518	2	580-1518	2
38.	Warranty Card	565-1070	1	565-1070	1	565-1070	1	565-1070	2	565-1070	2	565-1070	2
	Danger Decal Installation Inst.	369-1133	1	369-1133	1	369-1133	1	369-1133	1	369-1133	1	369-1133	1
	SUPPORT PACK 6—CARTON			0-8495-001	1			0-8495-001	1	0-8495-001	1	0-8495-001	2
	SUPPORT PACK 4—CARTON	0-8495-000	1			0-8495-000	2	0-8495-000	1	0-8495-000	2	0-8495-000	1
39.	Side Vertical	580-1519	4	580-1519	6	580-1519	8	580-1519	10	580-1519	14	580-1519	16
40.	Vertical Brace	580-1520	4	580-1520	6	580-1520	8	580-1520	10	580-1520	14	580-1520	16
41.	Bottom Rail Connector	580-1135	4	580-1135	6	580-1135	8	580-1135	10	580-1135	14	580-1135	16
42.	Foundation Beam	580-1200	4	580-1200	6	580-1200	8	580-1200	10	580-1200	14	580-1200	16
43.	Tension Strap	580-1225	2	580-1225	3	580-1225	4	580-1225	5	580-1225	7	580-1225	8
44.	Pressure Pad	580-1273	4	580-1273	6	580-1273	8	580-1273	10	580-1273	14	580-1273	16
*45.	Sheet Metal Screw, #10 x 3/8", Type AB	510-1000	48	510-1000	72	510-1000	96	510-1000	120	510-1000	168	510-1000	192
*46.	High Strength Bolt 1/4"-20 x 1/2", hex head	510-1018	16	510-1018	24	510-1018	32	510-1018	40	510-1018	56	510-1018	64
*47.	Hex Nut, 1/4"-20	511-1000	16	511-1000	24	511-1000	32	511-1000	40	511-1000	56	511-1000	64

*Screws are available in most hardware stores.

**For additional patch kits order Part No. 5604-00.

***If you have received a liner other than the one listed above, write the number of your liner in the space provided. #